

Rainbow Sundaya Kits

Cat.#	Description	SLK-060	SLK-120	SLK-200	SLK-200B
SUN-PV14	14W panel & frame	1	2		
SUN-PV50	50W panel & frame			1	1
SUN-BP40	40Ah battery pack	1	1		
SUN-BP55	55Ah battery pack			1	1
SUN-LT06	6W A-Light	2		2	
SUN-LT09	9W Multilight		2	1	
SUN-LTK01	10 pcs light kit				1
SUN-AC001	T-Con	1	2	2	6
SUN-AC002	S-Con		1	1	3
SUN-AC120	Cable 15m			1	1
SUN-AC100	Cable 10m		1		
SUN-AC160	Pull Switch		2	1	
SUN-AC150	20 Cable nails	4	4	4	
Total Cable Supplied (metres)		27	35	28	72
Number of Lights [†] @ Hours of operation		2@3½hrs	2@4½hrs	3@7hrs	10@3hrs
Weight		25 kg	33 kg	37 kg	43 kg
Volume		0.048 m³	0.063 m³	0.104 m³	0.115 m³

† Number of lights calculation assumes 2 Lumi @ 2W, 2 Lumi @ ½W. It is suggested to use only half the lights at any one time to double the hours. Calculated at 15° tilt facing due North for Port Moresby, Papua New Guinea and 50° tilt facing due North for Brisbane, Australia.

Solar Panel 14Wp

Cat.# SUN-PV14

This small amorphous silicon PV- panel with Moulded frame is especially suitable for small Economy type of lighting. Sundaya provides mounting structures to mount either 1, 2 or 3 panels on 1 pole on a rooftop. One panel in combination with Sundaya Apple S4 storage system generates an average of 60 watt-hours per day (based on 4-5kwh/m² insolation). The panel is manufactured by Free Energy Europe in France. It is rated at 14W and comes with a 10 year performance warranty.



PVS200 Solar Panel

Cat.# SUN-PV50

The kit is a convenient package complete with all installation materials to install the panel on your roof including the seal to prevent leaks. With an insolation of 4-5kWh/m²/day this set in combination with one of Sundaya Storage Systems provides 200Wh/day; sufficient for 33 hours of 6W light, or 5.5 hours 14" Sundaya colour TV, or any other 12VDC appliance. The Solar Panel is rated at 50W and is manufactured by General Electric.



Available locally from:



RAINBOW POWER COMPANY LTD

A.B.N. 74 003 323 420

1 Alternative Way, Nimbin, NSW, Australia 2480

phone: (02) 6689 1430
international: phone: +61 2 6689 1088
e-mail: sales@rpc.com.au

fax: (02) 6689 1109
international: fax: +61 2 6689 1109
web site: www.rpc.com.au

Battery Pack

Cat.# SUN-BP40 & SUN-BP55

The small battery pack is provided with SLK-060/120 and the larger one is provided with SLK-200. All battery packs are a plug and play wall mountable sealed lead acid storage system of 240 Wh capacity for the S4.240, 480 Wh for the S4.480 and 660 Wh capacity for the S4.660. All units include an S4 battery cabinet with built-in microprocessor based energy management system and have a clear LCD display that displays battery state of charge and charge/discharge or rest mode. These units are also equipped with an alarm to warn user when battery is one hour to forced disconnect due to a low battery state-of-charge.

Multilight

Cat.# SUN-LT09

The Multilight 2 is a high quality sturdy lamp. The Multilight 2 has a preheat start inverter and is equipped with a replaceable ULux tube. The lamp has a lifetime of over 100,000 On/Off cycles and over 10,000 burning hours. These lights are ideal for camping, boats and caravans. One or two multi-lights are included in these Kits. An optional polycarbonate lamp cover is available to make it waterproof to 25 metres.

A-Lights

Cat.# SUN-LT06

The A-light is the best performance ratio lamp in the industry. The A-light uses an economical Phillips 10W fluorescent tube and is equipped with the highest grade electronic components to ensure a long lifetime. The uniquely shaped UV- stabilised reflector takes care of a good diffusion of the light. Three of these lights are included in the Mini Lighting Kit. The A-light conforms to World Bank Specifications. Over 500,000 units have already been installed world-wide.

Ulite 9 (Cool Daylight) Light

The Ulite is a 12VDC instant start Compact Fluorescent Lamp with E17 Fitting. The Lamp is rated at 9W and has a lifetime of over 5,000 On/Off cycles and over 8,000 burning hours. Three lights with batten mount lampholders are supplied in the Mini Kit.

Lumi Light

The Lumi has two incandescent light bulbs of 0.5 and 2 Watt. The Lumi has two switches; one switch for On/Off and one switch for switching between 0.5 and 2 Watt light bulbs. The Lumi is most suitable in a bedroom or as a cosy light in your living room.

Optional Accessories for all Rainbow Sundaya Kits

- extra cable extensions, plugs & sockets
- extra lights & fittings
- spare tubes for A-lights & Multilights
- adaptor for radio / CD player
- timer, PIR motion detector
- waterproof fittings for Multilights
- lamp shades for Ulites
- generator / grid 10 amp backup charger

Sundaya Home System (SHS)

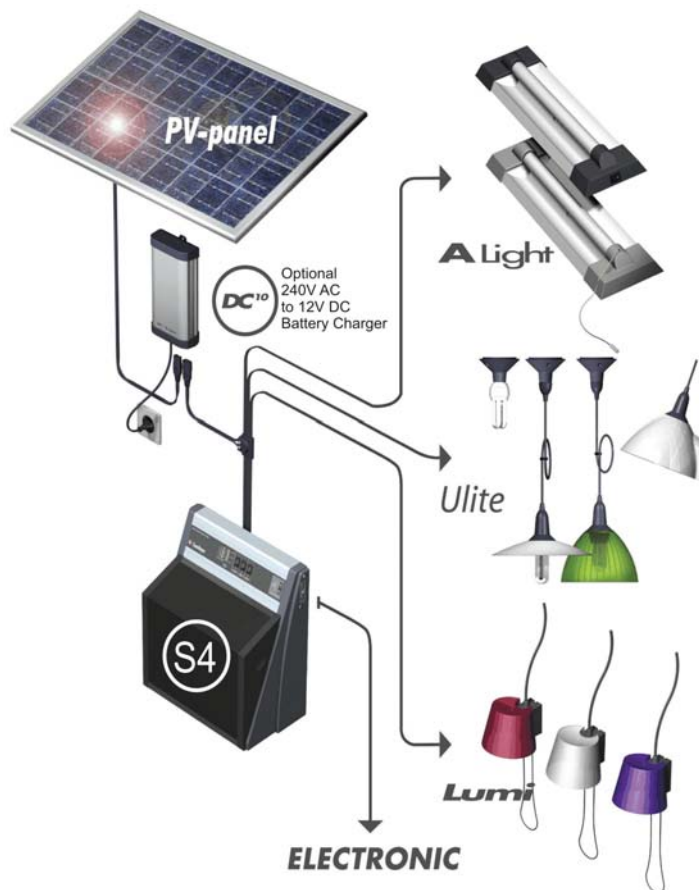

10L400 Standard Plus Lightkit

Cat.# SUN-200-P03

A complete set of lights and accessories, containing the 3 Ulite9, 2 Lumi White, 1 Lumi Red, 1 Lumi Purple, 3 A-lights, 3 Apollo, 1 socket outlets, and 3 Broco switches. The wide selection of lights allows you to light up several rooms, and to economise on power usage by allowing you to only select the amount of lighting, which you require for a specific task. For example, you might install two lights in your kitchen - over the workbench and over the kitchen table. Use one light when preparing your food and then the second light while eating. This saves power by only lighting up the area that you require. These 10 lights are supplied with the Moale Deluxe kit (SLK-200B).



Cat.# SUN-LTK01