

PV-ezRack PostMount 6 Planning and Installation Guide



Contents

1	Introduction	2
2	Installation Tools & Components	2
3	Installation Planning	3
4	Installation Guide	4
5	Service	8



CLEENERGY

1. Introduction

Clenergy PV-ezRack PostMount delivers flexible, effective and durable designs to mount 6 or 8 panels per pole, our PostMount systems are very high quality products designed to save you time and money on site.

All Clenergy PV-ezRack PostMount systems use our patented PV-ezRack rails ensuring strength, flexibility and ease of installation. The innovated adjustable angle cap enables the angle to be easily and quickly adjusted from 0 degree to 60 degree.

2. Installation tools & components

1. Installation Tools

- M12 Socket Wrench
- 6mm Allen Key
- measuring tape (5000mm)

2. Product Overview

Product component			
 PV-ezRack Rail	 PV-ezRack Clamps	 Steel Cap	 Adjust Tube
 PM6 Master Tube	 PM6 Landscape Tube	 PM6 Galvanize Pole	

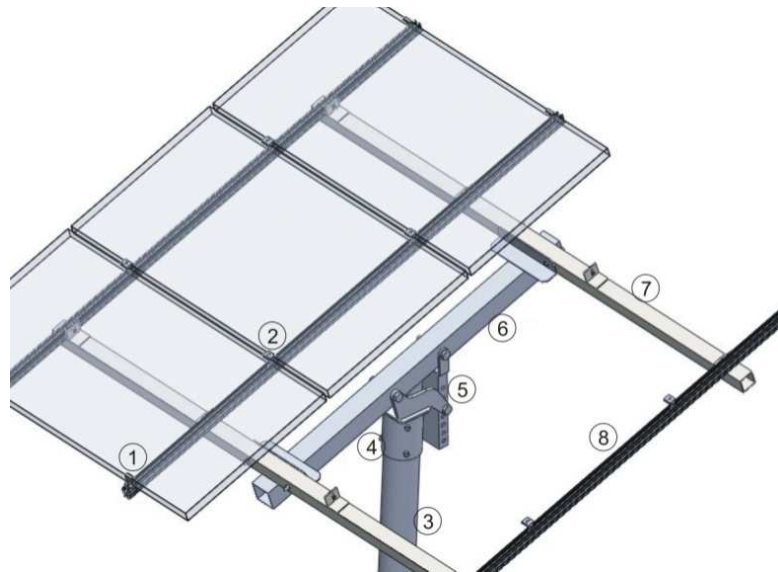

- | | |
|-------------------|-------------------|
| 1) End Clamp | 6) Master Tube |
| 2) Inter Clamp | 7) Landscape Tube |
| 3) Galvanize Pole | 8) PV-ezRack Rail |
| 4) Steel Cap | |
| 5) Adjust Tube | |

3. Installation Planning

This manual is specifically for the installation of PostMount 6 mounting system. Please read the following guide before installation.

1. Please confirm the wind conditions of the installation site. PostMount 6 mounting system can withstand a wind speed of maximum 42 m/s. Please contact us if the wind speed is over this limit, we will provide you with professional advice to optimize your system.

2. Please confirm the installation environment before installation. Since the installation involves a concrete bury, the soil test of installation site is required. Please confirm with your local construction company that the soil can be used.

4. Installation Guide

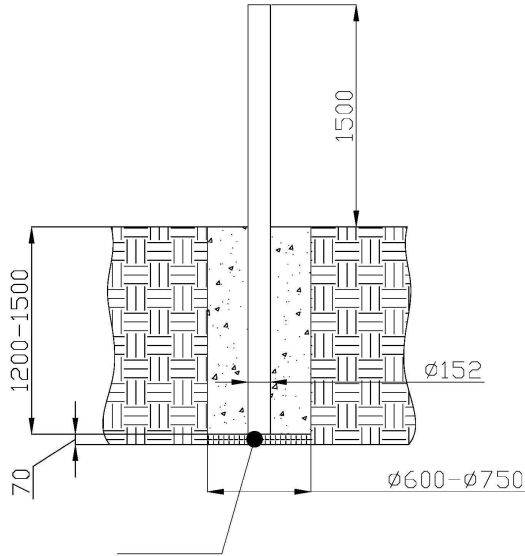
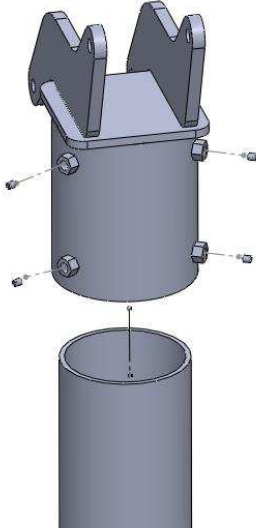
Installation Guide	
<p>1. Install PM6 Pole. Excavation diameter of 600-750mm, the depth of 1200-1500mm. Bottom covered with a layer of 70mm of gravel.</p>	
<p>2. Installation of the Steel Cap. Using six M12*25 hexagonal screws to fix in the Steel Cap to the Pole.</p>	



CLEENERGY

3. First fix the Master Tube to the Steel Cap using the Hex bolt M20*160, M20 nut, flat pad 20, elastic gasket 20.

Then fix the Adjustable Tube to the Master Tube using the Hex Bolt M20*160, flat pad 20, elastic gasket 20, M20 nut.

Finally, fix the Adjustable Tube to the Steel Cap using the Hex bolt M20*120 hex bolts, flat pad 20, elastic gasket 20, M20 nut.
Recommendation: In order to facilitate the installation of the panels, you can set the angle to 0° and at the end of the installation reset the system to the appropriate angle

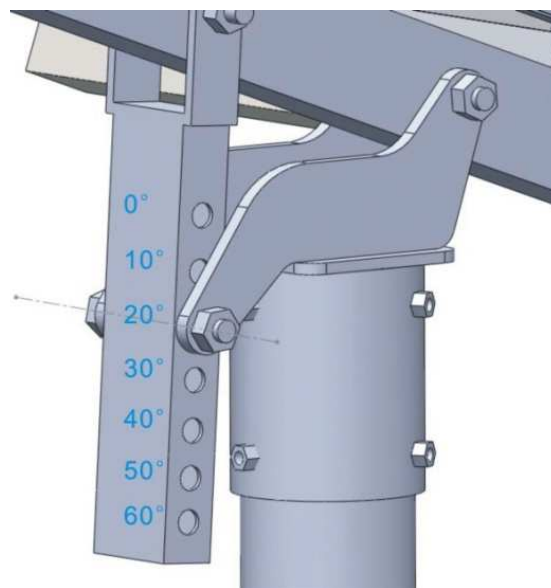
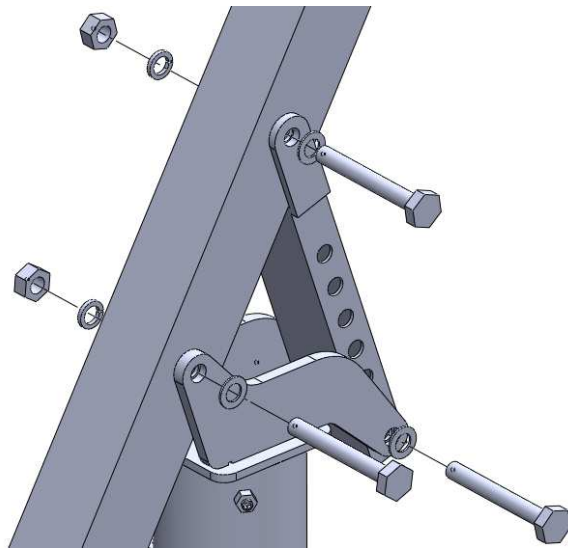

4. Installation of the Landscape Tube to the Master Tube using two M12 * 100 hex bolts, two M12 nuts, two flat pad 12.

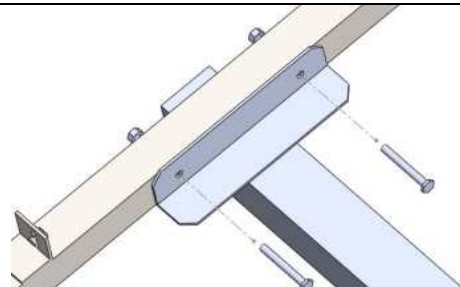



CLEENERGY

5. Ensure that $D1=D2$.

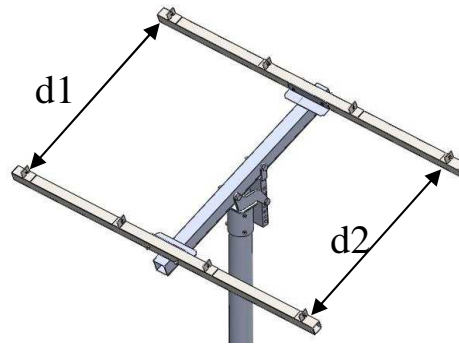

6. Installation of the PV-ezRack Rails to the Landscape Tube using the Z module leaving 480mm overhang.

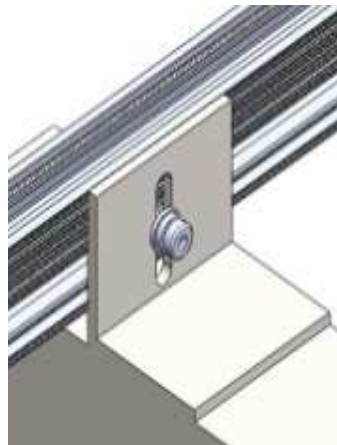
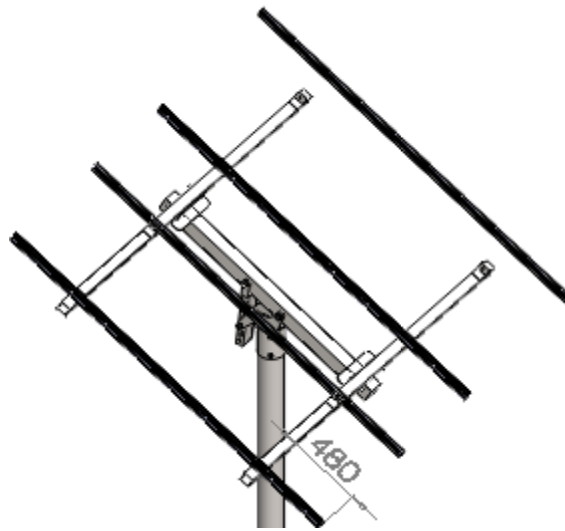



CLEENERGY

7. Mount the panels to the structure using the PV-ezRack End and Inter Clamps.

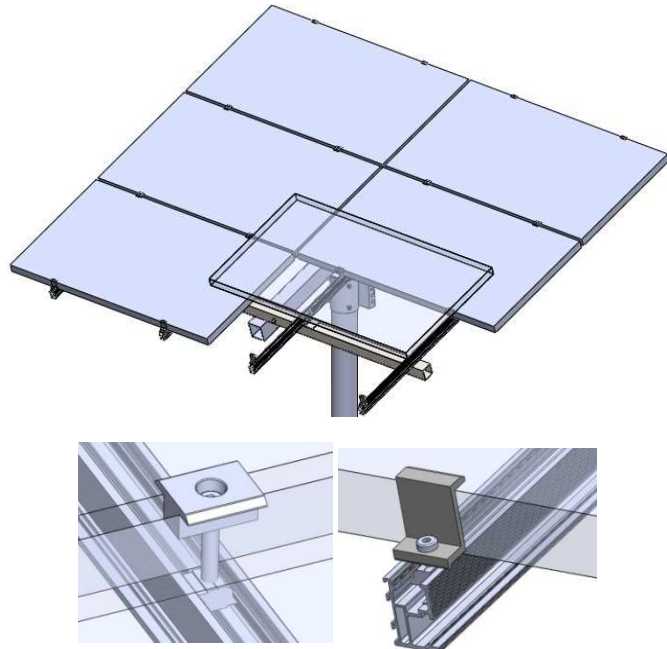

5. Service



10 year limited Product Warranty, 5 year limited Finish Warranty

Clenergy co. Ltd warrants to the original purchaser ("Purchaser") of product(s) that it manufactures ("Product") at the original installation site that the Product shall be free from defects in material and workmanship for a period of ten (10) years, except for the anodised finish, which finish shall be free from visible peeling, or cracking or chalking under normal atmospheric conditions for a period of five (5) years, from the earlier of 1) the date the installation of the Product is completed, or 2) 30 days after the purchase of the Product by the original Purchaser ("Finish Warranty").

The Finish Warranty does not apply to any foreign residue deposited on the finish. All installations in corrosive atmospheric conditions are excluded. The Finish Warranty is VOID if the practices specified by AAMA 609 & 610-02 – "Cleaning and Maintenance for Architecturally Finished Aluminum" (www.aamanet.org) are not followed by Purchaser. This Warranty does not cover damage to the Product that occurs during its shipment, storage, or installation.

This Warranty shall be VOID if installation of the Product is not performed in accordance with Clenergy's written installation instructions, or if the Product has been modified, repaired, or reworked in a manner not previously authorized by Clenergy IN WRITING, or if the Product is installed in an environment for which it was not designed. Clenergy shall not be liable for consequential, contingent or incidental damages arising out of the use of the Product by Purchaser under any circumstances.

If within the specified Warranty periods the Product shall be reasonably proven to be defective, then Clenergy shall repair or replace the defective Product, or any part thereof, in Clenergy's sole discretion. Such repair or replacement shall completely satisfy and discharge all of Clenergy's liability with respect to this limited Warranty. Under no circumstances shall Clenergy be liable for special, indirect or consequential damages arising out of or related to use by Purchaser of the Product.

Manufacturers of related items, such as PV modules and flashings, may provide written warranties of their own. Clenergy's limited Warranty covers only its Product, and not any related items.